

## NPN Plastic-Encapsulate Transistor

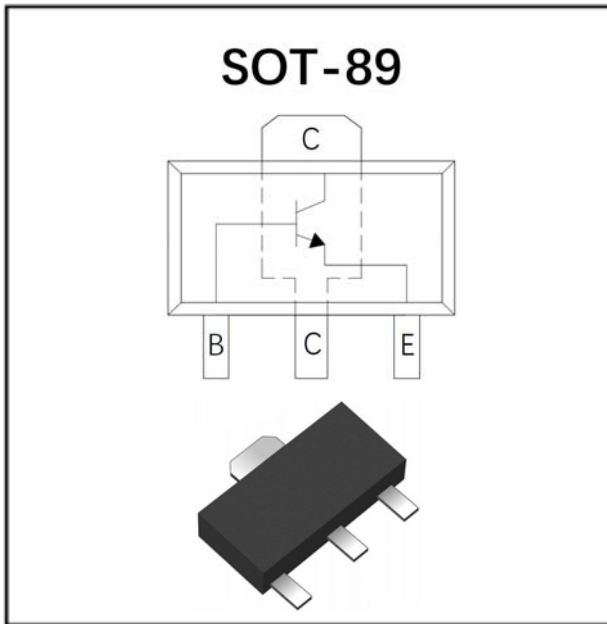

### Features

- Epoxy meets UL-94 V-0 flammability rating and halogen free
- Moisture Sensitivity Level 1
- High power dissipation capability
- Exposed heatsink for excellent thermal and electrical conductivity
- Part no. with suffix "Q" means AEC-Q101 qualified

### Application

- Linear voltage regulators、 Low-side switches
- Battery-driven devices、 MOSFET drivers
- Amplifiers

### Mechanical Data

- **Package:** SOT-89
- **Terminals:** Tin plated leads, solderable per J-STD-002 and JESD22-B102
- **Marking:** BD

### ■ Maximum Ratings (Ta=25°C unless otherwise noted)

Item	Symbol	Unit	Value
Minimum Collector-Emitter Voltage	$V_{CEO}$	V	45
Minimum Collector-Base Voltage	$V_{CBO}$	V	45
Minimum Emitter-Base Voltage	$V_{EBO}$	V	5
Collector Current	$I_C$	A	1
Collector Power Dissipation (*)	$P_C$	mW	500
Thermal Resistance From Junction To Ambient (*)	$R_{\theta JA}$	°C/W	250
Operation Junction Temperature	$T_j$	°C	-55 to +150
Storage Temperature	$T_{stg}$	°C	-55 to +150

(\*) Device mounted on FR-4 PCB 1.0 x 1.0 x 0.06 inch.



# BCX54-16Q

## ■Electrical Characteristics (Ta=25°C unless otherwise noted)

Item	Symbol	Unit	Conditions	Min	TYP	Max
Collector-Emitter Voltage	$V_{CEO}$	V	$I_C=10mA, I_B=0$	45		
Collector-Base Voltage	$V_{CBO}$	V	$I_C=100\mu A, I_E=0$	45		
Emitter-Base Voltage	$V_{EBO}$	V	$I_E=100\mu A, I_C=0$	5		
Collector-Base cut-off current	$I_{CBO}$	nA	$V_{CB}=30V$			100
Emitter-Base cut-off current	$I_{EBO}$	nA	$V_{EB}=5V$			100
DC Current Gain	$h_{FE}$		$V_{CE}=2V, I_C=5mA$	40		
	$h_{FE}$		$V_{CE}=2V, I_C=150mA$	63		250
	$h_{FE}$		$V_{CE}=2V, I_C=500mA$	25		
Collector-Emitter Saturation Voltage	$V_{CE(sat)}$	V	$I_C=500mA, I_B=50mA$			0.5
Base-Emitter Voltage	$V_{BE}$	V	$V_{CE}=2V, I_C=500mA$			1
Transition Frequency	$f_T$	MHz	$I_C=10mA, V_{CE}=5V, f=100MHz$		130	

## ■Ordering Information (Example)

PREFERRED P/N	PACKING CODE	UNIT WEIGHT(g)	MINIMUM PACKAGE(pcs)	INNER BOX QUANTITY(pcs)	OUTER CARTON QUANTITY(pcs)	DELIVERY MODE
BCX54-16Q	F2	Approximate 0.055	1000	8000	32000	7" reel

## ■Characteristics (Typical)

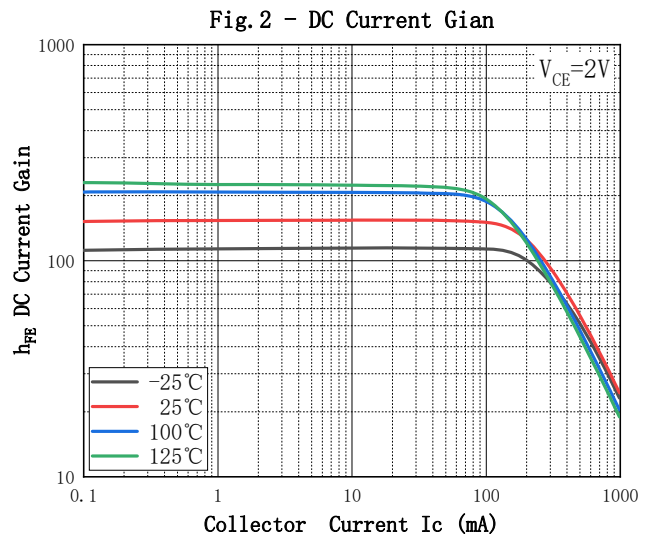
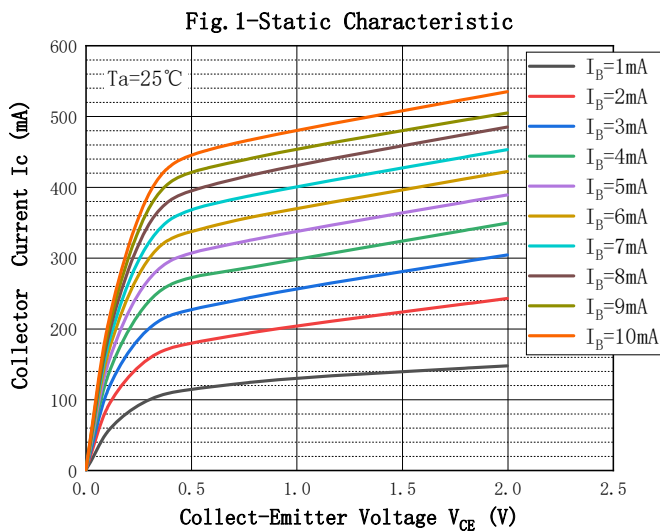



# BCX54-16Q

Fig. 3 - Collect-Emmitter Saturation Voltage

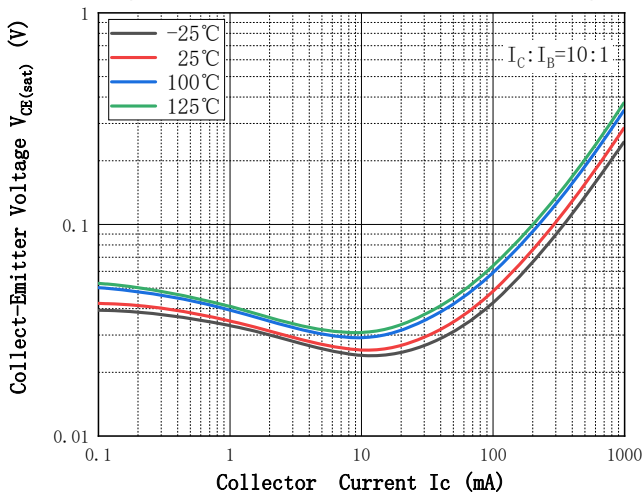

Fig. 4 - Base-Emmitter Voltage

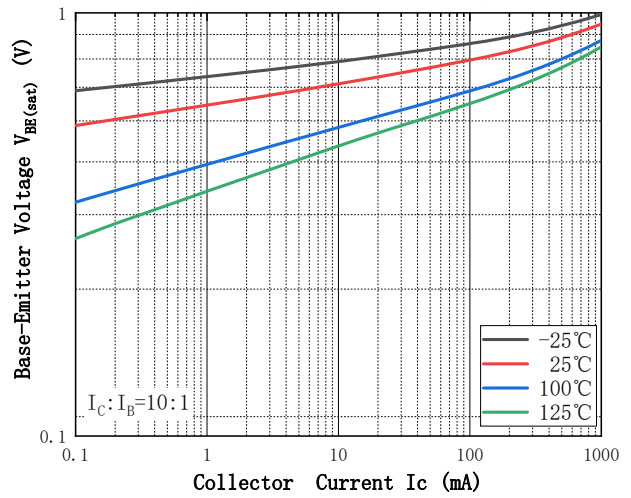

Fig. 5 - Base-Emmitter On Voltage

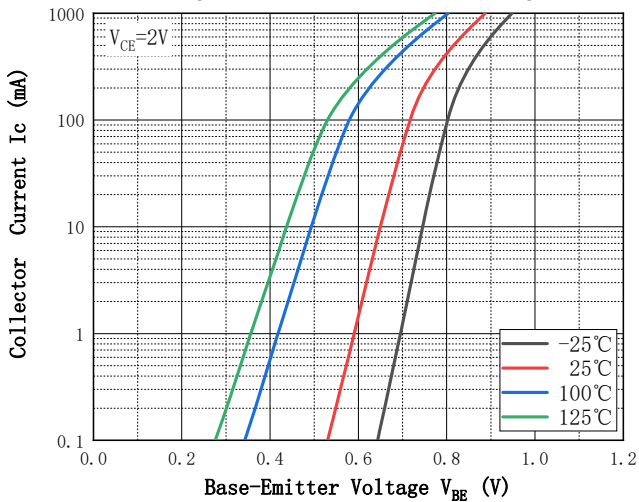

Fig. 6 -  $C_{ob}/C_{ib}-V_{CB}/V_{EB}$

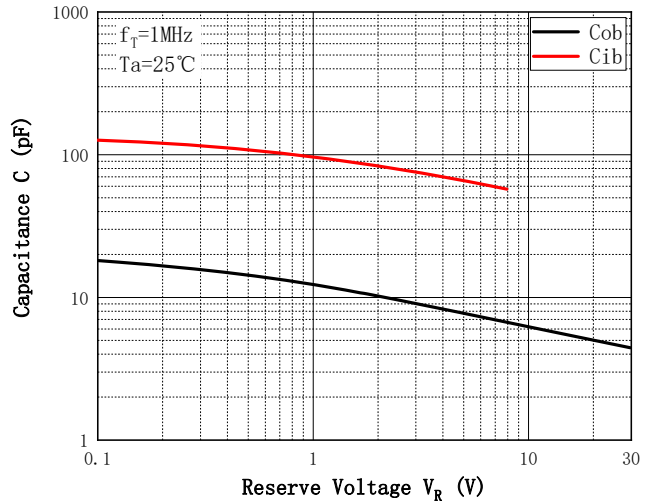
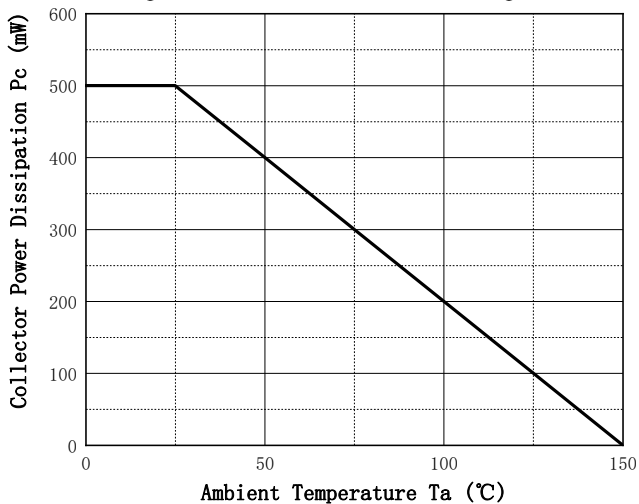

Fig. 7 - Collector Power Derating Curve





# BCX54-16Q

## ■SOT-89 Package Outline Dimensions

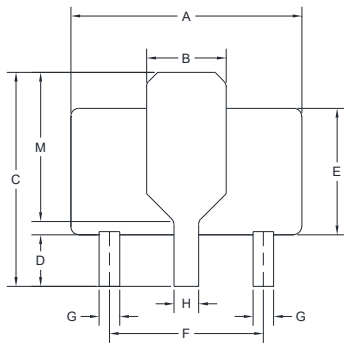

BOTTOM VIEW

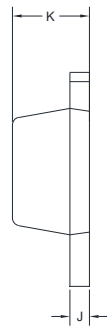

SIDE VIEW

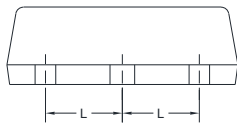

SIDE VIEW

DIM	DIMENSIONS			
	INCHES		MM	
	MIN.	MAX.	MIN.	MAX.
A	0.173	0.181	4.400	4.600
B	0.061 TYP.		1.550 TYP.	
C	0.155	0.167	3.940	4.250
D	0.031	0.047	0.800	1.200
E	0.094	0.102	2.400	2.600
F	0.118 TYP.		3.00 TYP.	
G	0.014	0.019	0.360	0.480
H	0.017	0.022	0.440	0.560
J	0.014	0.017	0.350	0.440
K	0.055	0.063	1.400	1.600
L	0.059 TYP.		1.500 TYP.	
M	0.108 TYP.		2.750 TYP.	

## ■SOT-89 Suggested Pad Layout

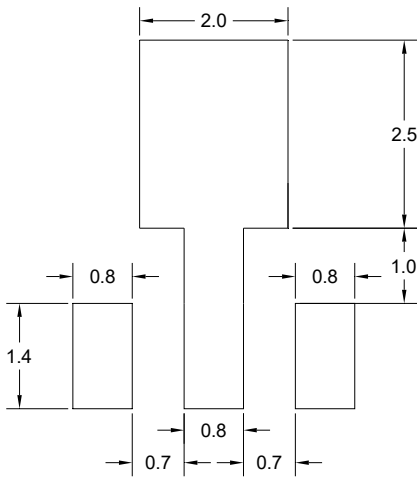

UNIT:MM

SUGGESTED SOLDER PAD LAYOUT



## BCX54-16Q

---

### Disclaimer

The information presented in this document is for reference only. Yangzhou Yangjie Electronic Technology Co., Ltd. reserves the right to make changes without notice for the specification of the products displayed herein to improve reliability, function or design or otherwise.

The product listed herein is designed to be used with automotive electronics, are not designed for use in medical, life-saving, lifesustaining, or military, Yangjie or anyone on its behalf, assumes no responsibility or liability for any damages resulting from such improper use of sale.

This publication supersedes & replaces all information previously supplied. For additional information, please visit our website [http:// www.21yangjie.com](http://www.21yangjie.com) , or consult your nearest Yangjie's sales office for further assistance.